

THIS DRAWING IS UNPUBLISHED. RELEASED FOR PUBLICATION  
 © COPYRIGHT 19 BY AMP INCORPORATED, HARRISBURG, PA. ALL INTERNATIONAL RIGHTS RESERVED. AMP PRODUCTS MAY BE COVERED BY U.S. AND FOREIGN PATENTS AND/OR PATENTS PENDING.

LOC		DIST		P		F		ZONE		LTR		REVISIONS			
AF		58										DESCRIPTION	DATE	APPROVED	
												D	REV & REL PER AF-7947	4/27/82	JR/GY

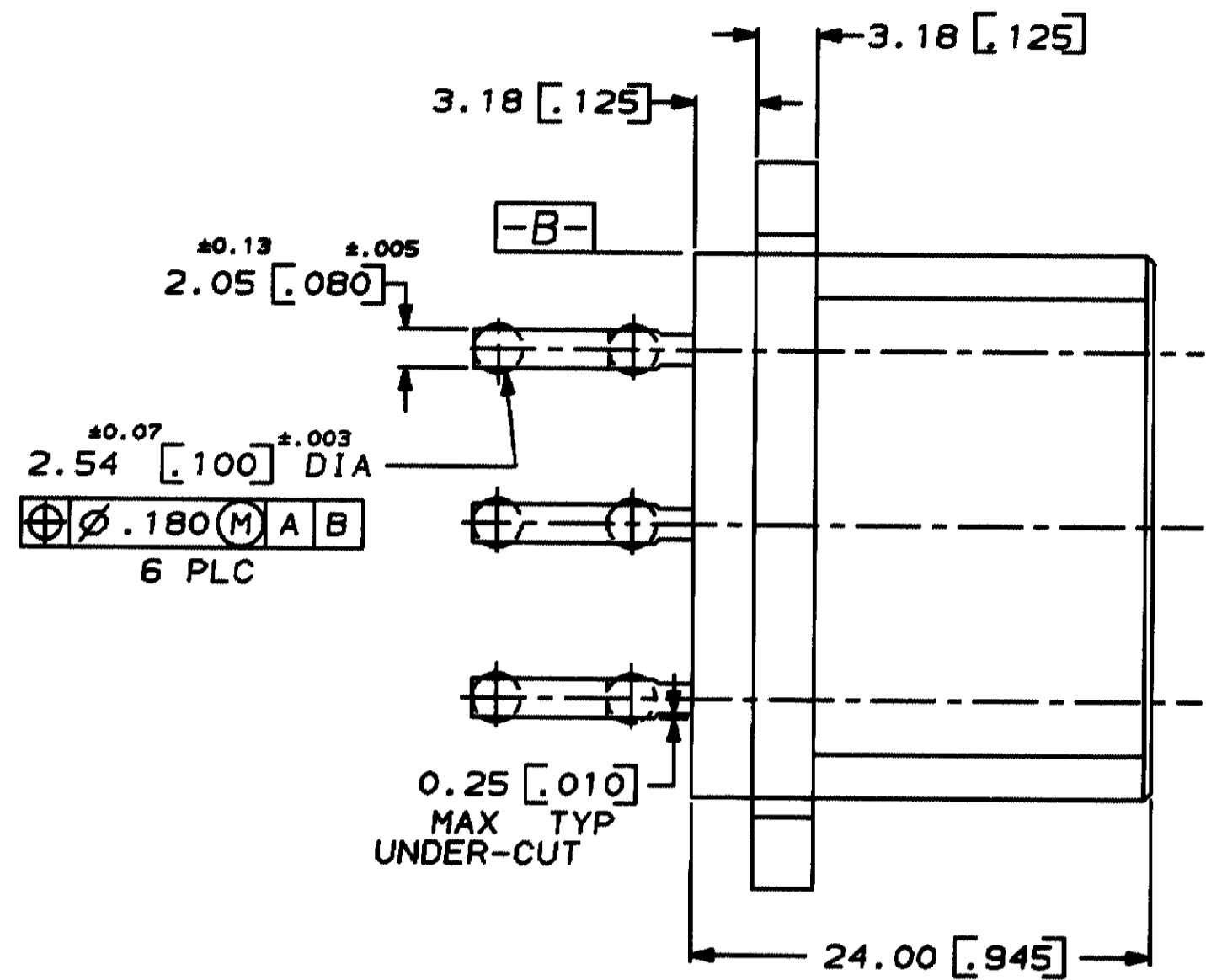

1 - DIMENSIONS IN BRACKETS ARE IN INCHES.

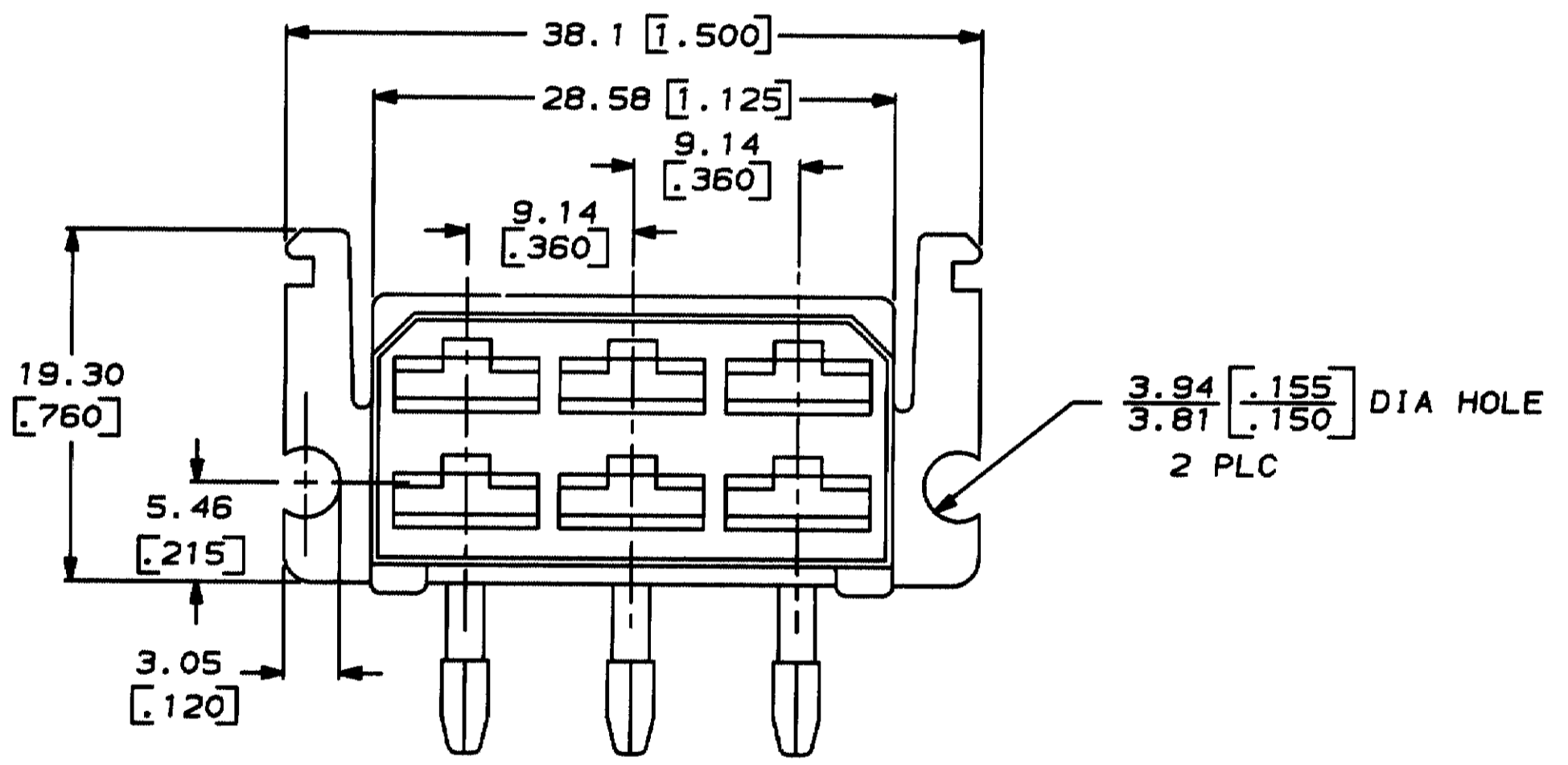
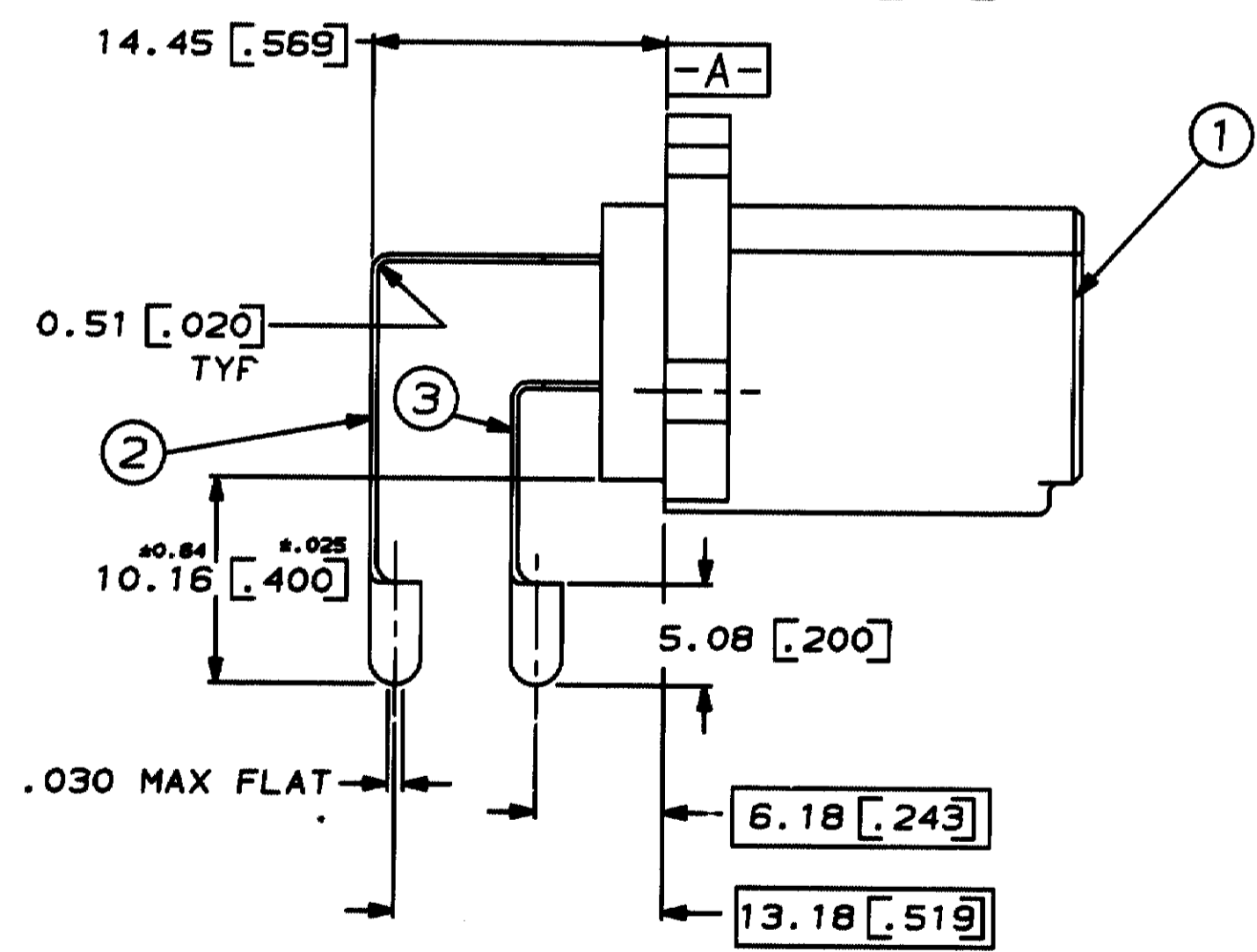

FINISH	MATERIAL	QUANTITY	DESCRIPTION	ITEM NO
TIN OVER COPPER	BRASS	3	.250 FASTIN-FASTON W/PIN	3
TIN OVER COPPER	BRASS	3	.250 FASTIN-FASTON W/PIN	2
NATURAL	NYLON 6/6 V2	1	.250 6 CIRCUIT FASTIN-FASTON HSG.	1
FINISH	MATERIAL	-1	DESCRIPTION	ITEM NO

UNLESS OTHERWISE SPECIFIED DIMENSIONS ARE IN INCHES TOLERANCES ON :		DR 12/1/86 JR R' TH	
2 PL DEC ± -		CHK 12/1/86 MS FEHER	
3 PL DEC ± 0.25 [0.010]		APPD 12/1/86 J GILLESPIE	
ANGLES ± -		APPD 12/1/86 R KUZO	
MATERIAL	SEE TABLE	PRODUCT SPEC	
FINISH	SEE TABLE	APPLICATION SPEC	
WEIGHT	-	-	

AMP INCORPORATED Harrisburg, Pa. 17105		
NAME RECEPTACLE ASS'Y, FASTIN-FASTON, .250 SERIES PCB MOUNT, 6 POSITION		
SIZE C	FSCM NO 00779	DRAWING NO 520875
SCALE NTS	SHEET 1 OF 1	

**METRIC**